

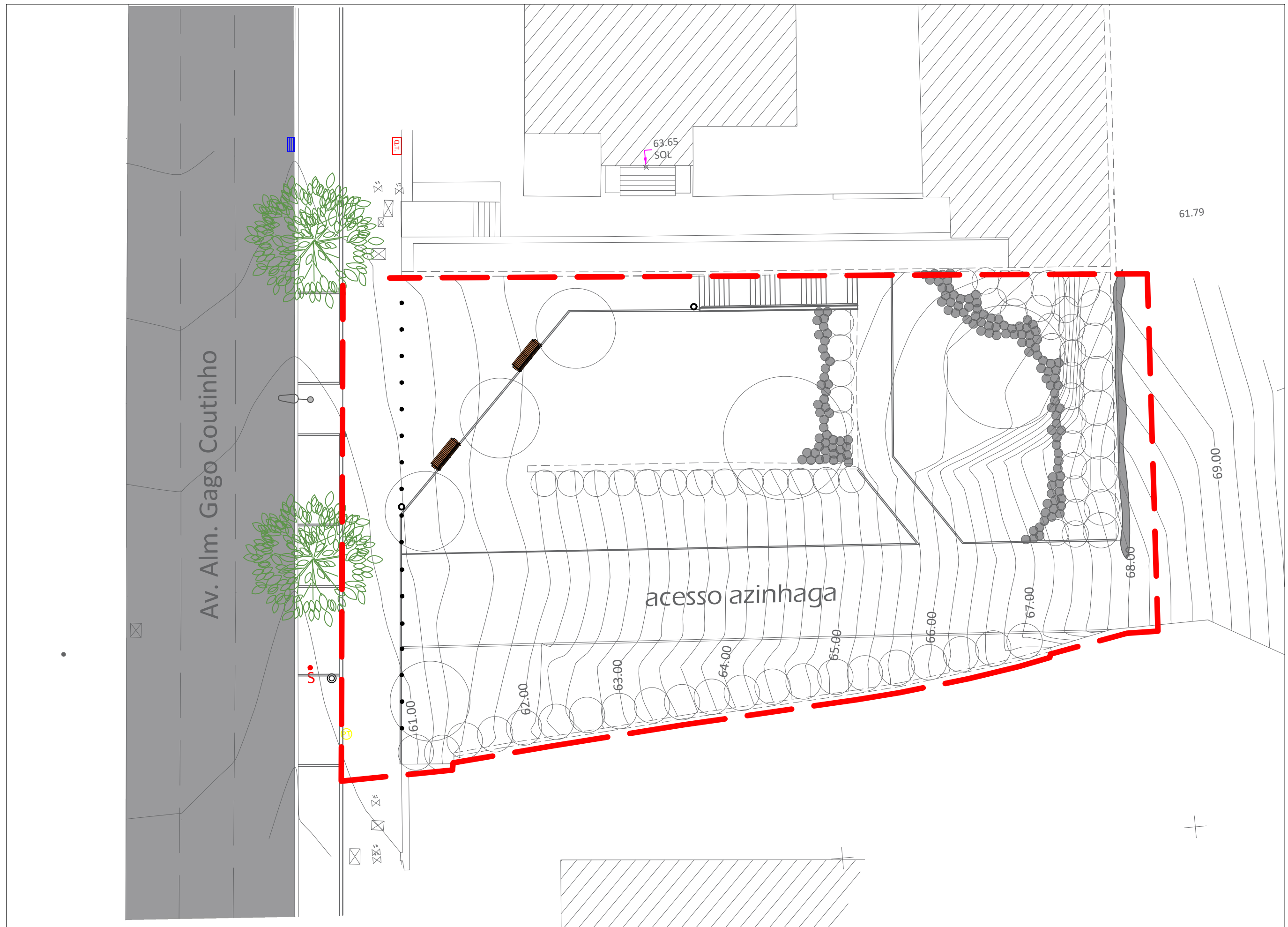



Não dispensa a verificação de todas as cotas e informações indicadas em obra.

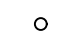

-  Bancos moderno da BRICANTEL ou equivalente
-  Pilaretes do Tipo P4 da FABRIGIMNO ou equivalente
-  Papeleiras do Tipo RESOPRE, ou equivalente

 Limite intervenção OP

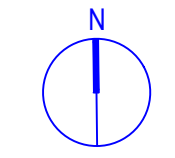

Técnico
Arq. Paisagista
Francisco Maia nº1362

Des. n.º
07

Designação
Plano MOb.

Obra e Local
Azinhaga das Teresinhas

Projecto
Projeto Execução

Escala
1:200

Data
janeiro 2021